

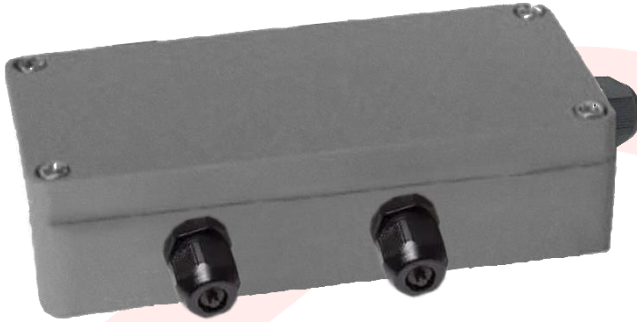

## Image



## Features

- ✓ BROSWEIGH Junction Boxes (J-Box) are preferred in systems where multiple loadcells are used for transmitting data to the indicator safely.
- ✓ There are models with 4, 6 and 8 outputs. Corner adjustments can be done easily thanks to the trimpods on it.
- ✓ BROSWEIGH Junction Boxes are designed for industrial environments and are suitable for dusty, humid and corrosive environmental conditions.

## Specifications

Loadcell Output Resistance Range	$\Omega$	340 to 1100
Loadcell Input Resistance Range	$\Omega$	340 to 1100
Excitation Recommended Voltage	V(AC&DC)	5 to 20
Excitation Maximum Voltage	V(AC&DC)	30
Loadcell Sensitivity Range	mV/V	0,6 - 3
Correction method		Excitation Trim
Trimming Range		20 ( $\pm 4$ )
Temperature Range Operation	$^{\circ}\text{C}$	-40 ~ +65
Ingress Protection		IP65
Element Material		ABS
Cable	mm	5 to 6,2



## Technical Drawings & Charts

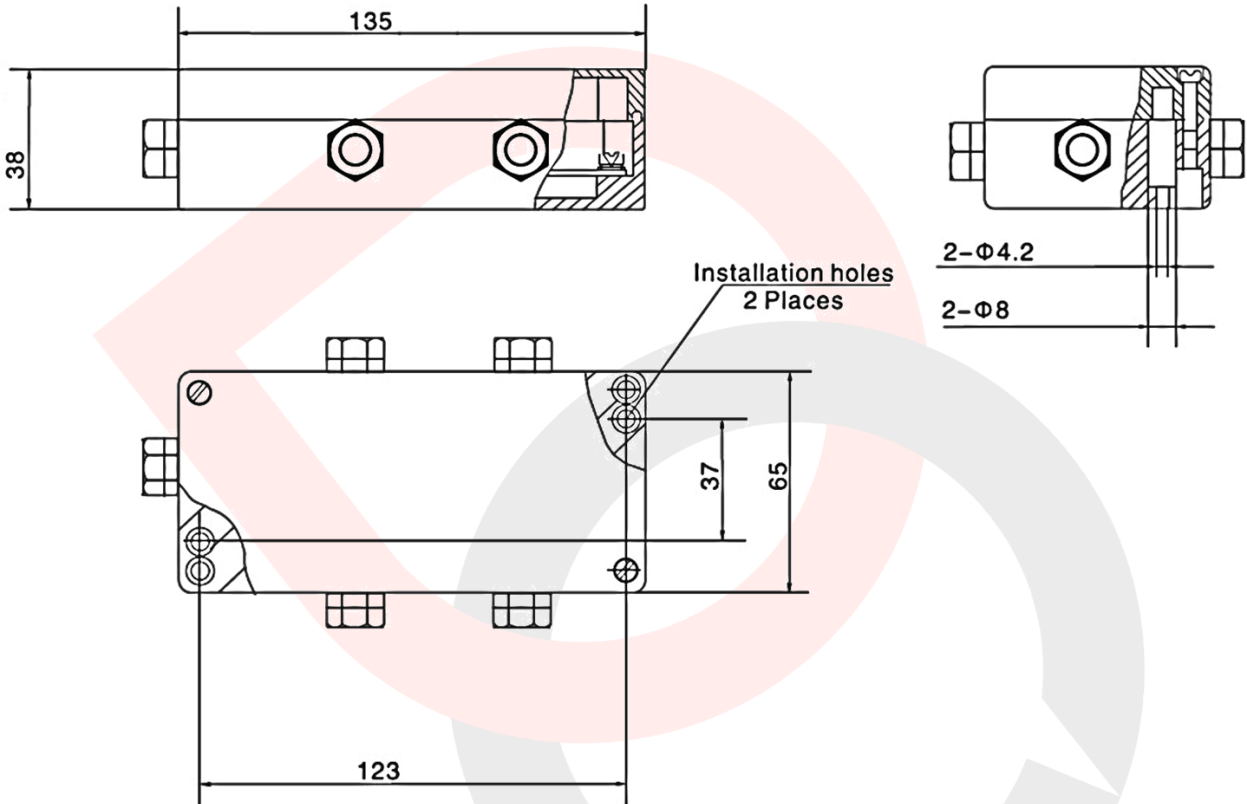

## Wiring Diagram

